

## Warranty

Arlec guarantees this product in accordance with the Australian Consumer Law.

Arlec also warrants to the original first purchaser of this product ("you") from a retailer that this product will be free of defects in materials and workmanship for a period of 24 months from the date of purchase; provided the product is not used other than for the purpose, or in a manner not within the scope of the recommendations and limitations, specified by Arlec, is new and not damaged at the time of purchase, has not been subjected to abuse, misuse, neglect or damage, has not been modified or repaired without the approval of Arlec and has not been used for commercial purposes ("Warranty").

If you wish to claim on the Warranty, you must, at your own expense, return the product, and provide proof of original purchase and your name, address and telephone number, to Arlec at the address below or the retailer from whom you originally purchased the product within 24 months from the date of purchase.

Arlec will (or authorise the retailer to) assess any claim you may make on the Warranty in the above manner and if, in Arlec's reasonable opinion, the Warranty applies, Arlec will at its own option and expense (or authorise the retailer to) replace the product with the same or similar product or repair the product and return it to you or refund the price you paid for the product. Arlec will bear its own expenses of doing those things, and you must bear any other expenses of claiming on the Warranty.

The Warranty is in addition to other rights and remedies you may have under a law in relation to the product to which the Warranty relates.

Our goods come with guarantees that cannot be excluded under the Australian Consumer Law. You are entitled to a replacement or refund for a major failure and for compensation for any other reasonably foreseeable loss or damage. You are also entitled to have the goods repaired or replaced if the goods fail to be of acceptable quality and the failure does not amount to a major failure.

# ARLEC

Arlec Australia Pty. Ltd. ACN 009 322 105 ("Arlec") gives the Warranty. Arlec's telephone number, address and email address are:

**Customer Service: (03) 9982 5111**  
**New Zealand Toll Free: 0800 003 329**

Building 3, 31 – 41 Joseph Street, Blackburn North, Victoria, 3130  
 Blackburn North LPO, P.O. Box 1065, Blackburn North, 3130  
 Email: [custservice@arlec.com.au](mailto:custservice@arlec.com.au)

© This instruction leaflet is subject to copyright and must not be reproduced, copied or otherwise used in any way or for any purpose without the consent in writing of the owner, Arlec Australia Pty Ltd (A.C.N. 009 322 105)

CPIN002908



# Portable Air Conditioner

## 10000 BTU/h 2.9kW

CWAC11

### INSTRUCTION MANUAL

LED Touch Panel



Remote Control



4 direction air flow





**Important! Please read these instructions carefully.**

Due to continuous research and development the specifications herein are subject to change without notice.

## SAFETY INSTRUCTIONS

- **DO NOT** use this unit for functions other than those described in this instruction manual.
  - **DO NOT** tilt the unit. Always keep in upright position. If unit has not been kept in upright position, wait for at least 24 hours before operating the unit.
  - **DO NOT** cover or obstruct the air inlet or outlet grilles.
  - **DO NOT** use the unit in a wet room, such as a bathroom or laundry.
  - **DO NOT** sit or place articles on the unit.
  - **DO NOT** touch the unit with wet hands or bare feet.
  - **DO NOT** let chemical substances come into contact with the unit.
  - **DO NOT** use the unit in the presence of inflammable substances or vapour such as alcohol, insecticides, petrol etc.
  - **DO NOT** use the mains plug to start and stop the unit.
  - **DO NOT** pull the supply cord or place it near a heat source. Always unwind the cord completely to avoid overheating. If the supply cord is damaged it must be replaced by the service agent or a similarly qualified person, in order to avoid a hazard.
  - **DO NOT** allow children to play with this appliance. This appliance is not intended for use by children or infirm persons without supervision.
  - **DO NOT** conduct repairs on this unit. It has been built in accordance with relevant safety and performance standards. An electrical specialist must carry out all repairs.
  - **DO NOT** use the unit without the filter fitted.
  - **ALWAYS** unplug the unit from the mains before maintenance or cleaning.
  - **ALWAYS** use the switch on the control panel to start and stop the unit.
  - **ALWAYS** keep a clearance of at least 500mm from walls furniture and curtains.
  - **ALWAYS** turn off the unit when not in use.
- Connect to properly earthed outlets only.

**Do not use outdoors.**

**Do not operate after the unit malfunctions, has been dropped or damaged in any manner. Return unit to suitably qualified facility for examination, electrical or mechanical adjustment or repair.**

**There are no serviceable parts installed in the unit.**

**Keep these instructions handy for future reference**

## ELECTRICAL CONNECTIONS

**Before you plug the appliance into mains socket, check if:**

**The mains wall power supply corresponds to the value indicated on the product rating label placed on back of the unit.**

**Power rating of the mains wall socket is adequate for the appliance.**

**Mains wall socket is properly earthed.**

## ENERGY SAVING TIPS

**Use the unit in the recommended room size of up to 20m<sup>2</sup> (assuming standard 2.4m ceiling height)**

- **Do not** locate the air conditioner where furniture or other objects can obstruct the air flow.
- **Keep blinds/curtains closed during the sunniest part of the day.**
- **Close the fireplace damper, floor and/ or wall registers, so cool air does not escape through the chimney or duct work.**
- **Keep the air filter clean.**
- **Set the unit to maximum cooling and high speed ventilation for the initial startup, then adjust the unit down to a more comfortable setting as required.**

## IDENTIFICATION

- 1 Air Outlet
- 2 Adjustable air flow louvres
- 3 Touch control panel
- 4 Air Filters
- 5 Remote control receiver
- 6 Transport handle
- 7 Exhaust outlet
- 8 Power cord
- 9 Cord storage
- 10 Drain port
- 11 Casters
- 12 Hose inlet
- 13 Exhaust hose
- 14 Hose outlet
- 15 Sliding window adaptor
- 16 Remote control
- 17 Caster locks
- 18 Suction cups

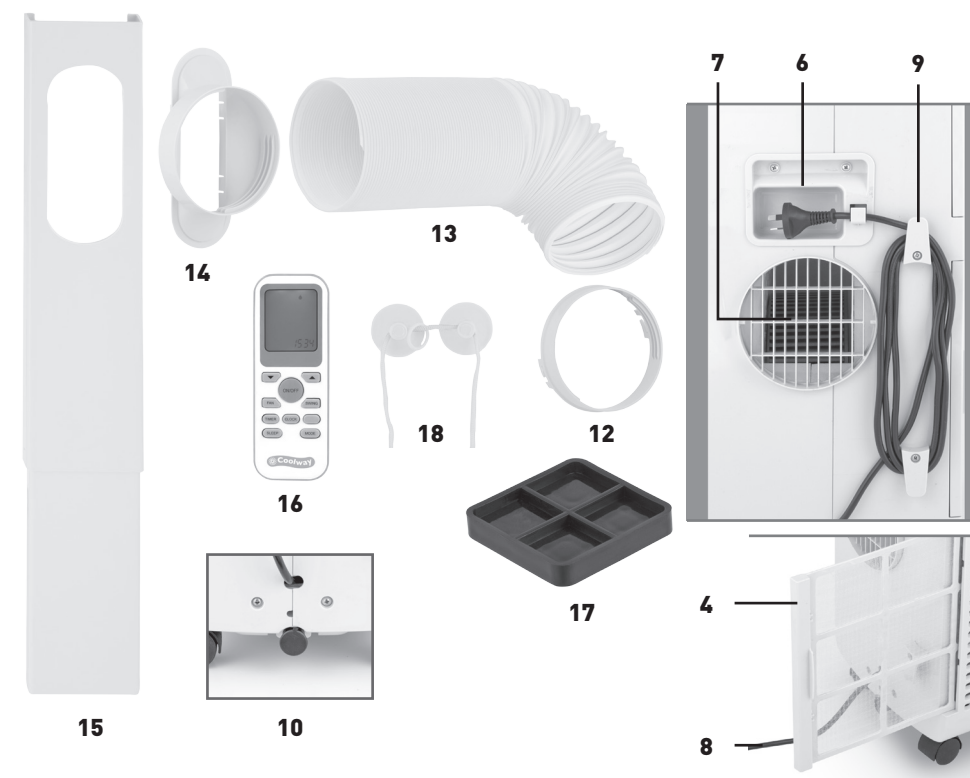
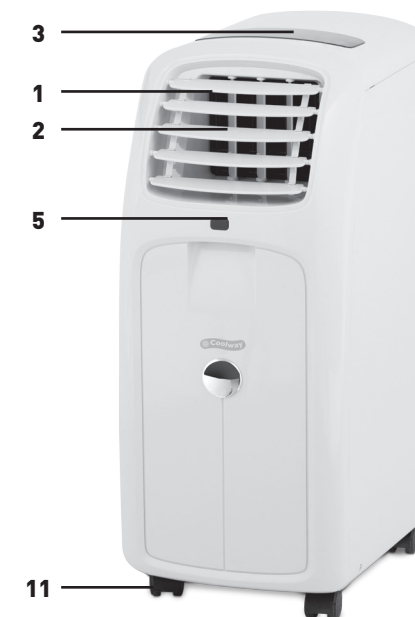

## ASSEMBLY

### FITTING THE EXHAUST HOSE

This air conditioner is required to have the hose fitted to an external opening to exhaust the hot air.

The hose can be extended from 390mm to 1500mm long, however it is recommended to use the shortest possible length. Pull the end of the air outlet duct apart by several turns.

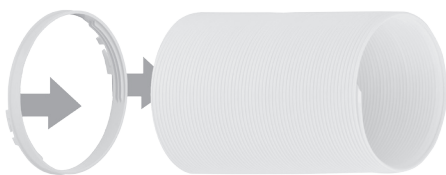

Attach the hose inlet to the pulled apart end of the hose. Place the hose inlet over the exhaust outlet and turn it in anti clockwise direction to lock it in.



Prevent any bow or bend in the middle of the hose, as this will trap hot exhaust air, which will radiate into the room and cause the unit to shut off automatically (due to overheating)

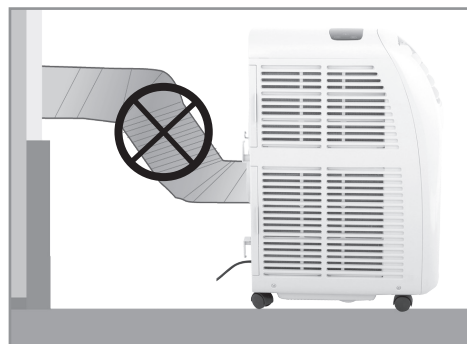

**IMPORTANT! The hose length has been specifically designed for this product. Do not replace or lengthen the hose with attachments. If the venting of the exhaust air is inhibited in any way the unit may over heat and shut off.**

### TO ATTACH

- 1 Slide window open
- 2 Insert sliding window adaptor into opening, telescope window adaptor to fit window.
- 3 Insert screw into closest available hole in edge of kit to hold it in position.
- 4 Attach the hose outlet onto flexible hose.
- 5 Insert hose outlet into window adaptor and clip into place.
- 6 Partially close window to secure window kit.
- 7 If you have a double window use the suction cups provided to hold the windows in place.
- 8 Your appliance is ready for use.

HORIZONTAL APPLICATION

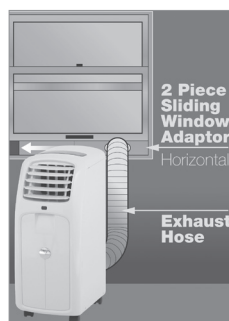

VERTICAL APPLICATION



### CASTER LOCKS

Two caster locks are supplied with the unit. Place the locks underneath the rear casters to lock-in the unit in place.

## DESCRIPTION OF CONTROL PANEL

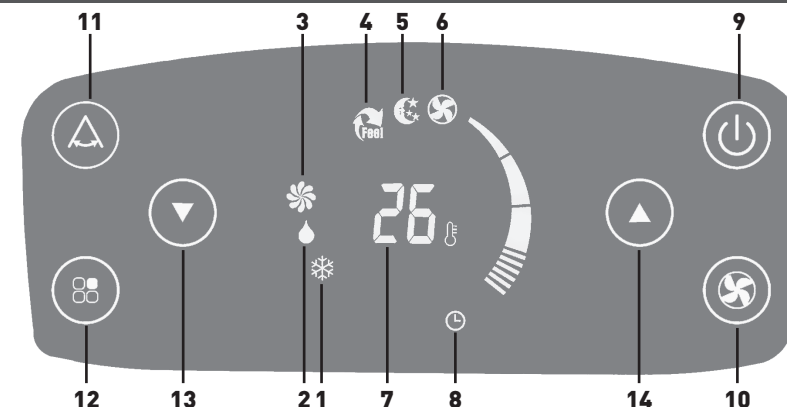

- |                         |                               |
|-------------------------|-------------------------------|
| 1 COOL Mode             | 8 Timer indicator             |
| 2 DRY Mode              | 9 Power ON / OFF touch key    |
| 3 FAN Mode              | 10 Fan speed adjustment key   |
| 4 SMART Mode            | 11 SWING FUNCTION touch key   |
| 5 SLEEP Mode            | 12 Mode selection touch key   |
| 6 Fan speed indicator   | 13 Down temperature touch key |
| 7 Temperature indicator | 14 Up temperature touch key   |

## OPERATION



### TURNING ON /OFF

To power the unit ensure that the power plug is plugged into an appropriate 240Vac receptacle and switch power on at the wall outlet.

Once the power is applied the unit will beep three times and the display will come up with two lines, the unit will be in a standby mode.

Press the Power ON touch key and the unit will start operating in the last selected settings.

**IMPORTANT! To prolong the life of the compressor, wait for at least 3 minutes before turning on the unit, after it has been switched off.**

Never turn the air conditioner off by unplugging from the mains wall outlet. Always use the Power ON button to turn off the unit and then wait for few minutes before unplugging the mains power cord.



### COOL Mode

- Press the **MODE** Key repeatedly until the COOL symbol appears on the display. This indicates the unit is set in cool mode.
- Press the **UP** **DOWN** key to set room temperature as desired between 18°C to 32°C.
- Press the **FAN** key to change the fan speed from Low to Medium to High to Auto and the speed indicator will change on the display panel to the selected fan speed settings as shown below.

When the fan speed is set to AUTO the unit will select the most suitable fan speed from Low, Medium and High as per the set temperature.

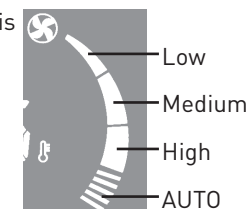



### DRY Mode

- Press the **MODE** key repeatedly until the DRY mode symbol appears on the display.
- In Dry mode fan speed is preset. Speed button is not available. The temperature can't be set either.
- Dry mode cannot be used to cool the room, it is ideal to reduce room humidity.

**\*See water drainage section to drain the condensate (water) in the unit.**



### FAN Mode

- Press the **MODE** key repeatedly until the FAN mode symbol appears on the display.
- Press the **FAN** key to change the fan speed from Low to Medium to High and the speed indicator will change on the display panel to the selected fan speed settings.

**In this mode Fan speed cannot be set to AUTO**

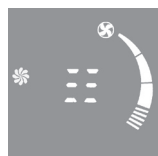

### SMART Mode

- Press the **MODE** key repeatedly until the SMART mode symbol appears on the display.
- In this mode unit will enter into a preset algorithm which will decide which mode to activate (cool or fan) according to the room temperature.
- To set this mode press the MODE button repeatedly until the SMART symbol appears on the display.
- Fan speed is set to AUTO in this mode and cannot be adjusted.



## REMOTE CONTROL

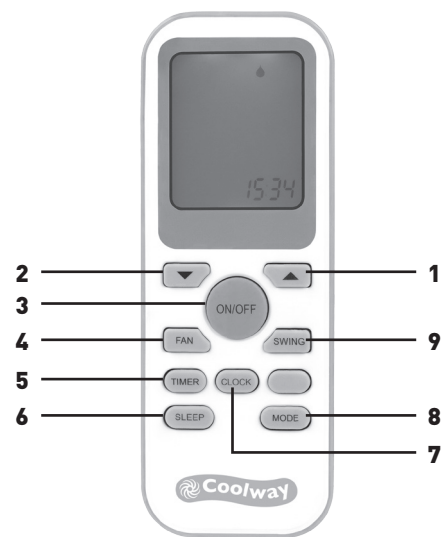

- Time & temperature increment button
- Time & temperature decrement button
- Power on /off button
- Fan speed button
- Timer button
- Sleep function button
- Clock button
- Mode selection button
- Swing on/off button

### REMOTE DISPLAY

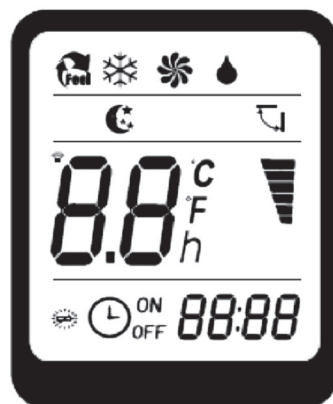

	SMART Mode Indicator
	COOLING Indicator
	DEHUMIDIFYING Indicator
	FAN ONLY OPERATION Indicator
	SIGNAL RECEPTION Indicator
	TIMER OFF Indicator
	TIMER ON Indicator
	AUTO FAN Indicator
	LOW FAN SPEED Indicator
	MEDIUM FAN SPEED Indicator
	HIGH FAN SPEED Indicator
	SLEEP Indicator
	LOUVRES SWING Indicator
	BATTERY Indicator
	CLOCK Indicator

### REMOTE CONTROL OPERATION:

- For the remote control to operate correctly the remote handset has to be in line of sight of receiver (attached to the front of unit below the air vents). There will be no change in the function of the unit if the remote transmitter handset is not in line of sight of the unit or if there are any obstacles between the remote control and receiver.
- Each time when there is a change in the function of the unit it will beep which indicates that the receiver attached to the unit has sensed the button press of the remote.
- If the remote transmitter is not in line of sight of the receiver and button is pressed the display on the remote LCD will change according to the button pressed but there will be no change in the function of the unit.

- The remote has a backlight option, to turn on the backlight press any button for 4 secs.

### BATTERY REPLACEMENT

- Slide the battery cover out.
- Insert two AAA size 1.5V batteries into the battery compartment making sure the polarities are correct, alkaline batteries recommended
- Refit the battery cover
- When the batteries go low the remote display will come up with the battery low indicator, replace both the batteries with fresh alkaline batteries.

### DIP SWITCH POSITION

Before you refit the battery housing cover ensure the DIP switch is set to correct position as described below.

**Cooling:** The remote control is set for COOLING MODE ONLY. If slide the switch UP to ON position the remote will have both Cool and Heat mode. This unit has no HEAT mode so there will not change in function when the HEAT mode is selected.



**Fahrenheit:** The temperature display on the remote LCD display will be in degree fahrenheit.



**Celsius:** The temperature display on the remote LCD display will be in degree Celsius



**Note: To change the settings the switch position must be adjusted first and then the batteries must be inserted. By DEFAULT the temperature on the unit will be displayed in Degree Celsius.**



### ON/OFF Button

Press the **ON/OFF** button to turn the unit ON or OFF.

Each time the unit is turned ON it will start operation in last selected mode



**CLOCK Button**

To set the correct time of the day, press the clock button.

Once the button marked **CLOCK** is pressed the clock hour and minute display will start to flash, using the **UP & DOWN** button adjust the correct time of the day. Each time the **UP/DOWN** button is pressed the time will increment or decrement by 1 minute. After the correct time is set press the **CLOCK** button to store the time.

**SWING FUNCTION**

Press this button and the vertical louvers will move sideways. Swing icon will appear on the display of the unit which will indicate that the swing function is activated.

Press the same button again to stop the swing function.

**SLEEP FUNCTION**

Under this function the unit maintains the room temperature and humidity at optimum level with silent operation. The unit will run in a preset programmed algorithm which will vary the set temperature after every

preset time interval. The unit will be turned off after 8 hours and will be in **STAND BY** mode.

Fan speed cannot be adjusted and is always set to low under this function.

**To SET:**

Select the desired mode of operation – **COOL / DRY** or **SMART**.

Press the **SLEEP** button, sleep icon will appear on the display and the remote which will indicate the unit is set in **SLEEP** function.

In **SLEEP** function if the unit is running in **COOL** mode, after each hour the set temperature is increased by 1°C, this happens for the first two hours after which the unit will run at set temperature + 2°C for remaining 6 hours before it is switched off.

In **DRY** mode the dehumidifying power of the appliance is partially reduced every hour for the first two hours and then the unit will run for 6 hrs at the reduced dehumidifying power before it goes in **STANDBY** mode.

**TIMER**

Timer function is used to set the **ON** or **OFF** time of the unit. This function can only be set using the remote control.

**TIMER ON**

This function is used to start the unit after a specific time interval.

**To set the ON Time**

- Turn the unit **ON** and select the mode in which you want your unit to run when the selected time interval is elapsed, example Cooling mode, 25°C fan speed high.
- Press the **ON/OFF** button to switch the unit in **STANDBY** mode.
- Press the **TIMER** button; the remote handset will come up with the time icon and **ON** next to it.
- Set the time after which you want the unit to be turned **ON** using the **UP / DOWN** button.
- Once the selected time interval is set press the **TIMER** button again to store the time interval in the memory.

- The unit will start operating the mode selected when the preset time is reached.
- To cancel the timer setting, press the **TIMER** button.

**TIMER OFF**

This function is used to turn OFF the unit after a specific time interval.

**To set the OFF time:**

- Turn the unit **ON** if the unit is not running to start, press the **TIMER** button once. The remote handset will display the time icon and **OFF** next to it.
- Set the time after which you want the unit to be turned **OFF** using the **UP / DOWN** button.
- Once the selected time is set press the **TIMER** button again to store the off time interval in the memory.
- The unit will be turned **OFF** when the preset time is reached and will be in standby mode.
- To cancel the timer setting, press the **TIMER** button.

**Note: In both the timer modes the time interval can be incremental by 30 mins. In an event of power failure the timer need to be reprogrammed. Once the time is set press the CLOCK button to switch to the current time display if required.**

**Disposal of the unit**

As required by Federal Government Regulations, prior to un installing or disposing of this air conditioner the refrigerant gas contained in this unit **MUST** be removed and disposed of via a licensed refrigeration mechanic. Please contact your local air conditioning service centre to arrange for proper gas removal and disposal.

**WATER DRAINAGE**

This product has a self-evaporative system. The condensing water will be recycled to cool the condenser. This not only improves cooling efficiency, but also saves energy.

When in Cool or Fan mode, there's no need for water drainage. The unit is equipped with a fail safe device, if the water tank fills. So during dehumidifying mode, when the water in the water tray exceeds the alarm level, the unit will stop completely and the control panel will display **FL**. This indicates the water tank is **FULL**, the compressor and fan will not restart until the tank has been drained.

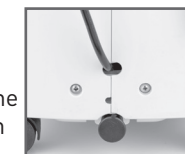
**MANUAL DRAIN**

Once the unit shuts down upon full water, turn off the power of the unit and then unplug the power plug.

**Note:** Move the unit carefully to avoid spillage of water in the water tray at the bottom of the unit.

Put a vessel / container that will hold the water below the water outlet at the back of the unit.

Screw off the drain cap and the water will flow into the vessel that holds water automatically.

**Note**

- 1 Protect the drain cap properly.
- 2 Tilt the unit slightly backward when draining.
- 3 If the vessel that holds water cannot hold all water in the unit, before the vessel that holds water is full of water, block the water outlet with the drain cap as soon as possible to prevent the water from flowing onto the ground or carpet.
- 4 Once the water is fully drained, screw on the drain cap tightly.

**Note:** Turn on the unit only after the drain cap is installed properly; otherwise, the condensate of the unit will flow onto the ground or carpet.

**Note:** If the water full alarm is often on, there may be some malfunction. Contact the service centre for advise/ help/service. Alternatively, in extreme humidity in tropical zones, the unit may not be able to evaporate the condensing water effectively, in this instance, follow the same procedure for dehumidifying mode.

## MAINTENANCE

Prior to maintenance and servicing of the unit, turn off the power and unplug the plug.

### Surface cleaning

Clean the surface of the unit with wet soft cloth. Do not use chemical solvents such as alcohol and gasoline; otherwise, the surface of the air conditioner may be damaged and even the whole unit may be damaged.

### Cleaning of the filter frame and filter mesh

Clean the filter mesh once every two weeks. If the filter frame and filter mesh are clogged with dust, the function of the air-conditioner may decrease

- 1 Grip the gripping position of the filter frame and take out the filter frame gently in the direction shown by the arrow.

**Note:** When taking out the filter frame, the force shall be applied evenly to avoid twisting or damage of the filter frame. Be sure to take out the filter frame first and then take out the filter mesh.

- 2 Use a vacuum cleaner to remove the dust from the filter. If the frame is very dusty place it into warm water (about 40°) to which neutral cleaner is added for cleaning and then dry them in the shade.



**Note:** Do not damage the mesh fabric on the filter frame and filter mesh.

- 3 To put the filter frame back, point the back end of the filter mesh towards the socket and then push the filter mesh evenly and gently into the socket.

### End of Season Storage

- 1 Screw off the drain cap and drain the water in the water tray to another vessel that holds water.

**Note:** The tilt angle of the unit shall not be greater than 30 degrees.

- 2 Start the unit, turn the mode to the low fan speed state of the air supply mode, keep this state for half a day and dry the interior of the unit to prevent mold.
- 3 Turn off the unit, unplug the power plug, wrap the power cord around the wire-winding post, install the water plug and drain cap.
- 4 Remove the exhaust hose assembly and keep it properly.
- 5 Pack the air-conditioner properly with soft plastic bag, put the unit in a dry place & take appropriate dust-proof measures, and keep the unit out of the reach of children.
- 6 Take out the batteries of the remote control and keep it properly.

**Note:** Ensure that the unit is put in a dry place. All accessories of the unit shall be protected properly.

## TROUBLESHOOTING

### Unit does not operate

- Is the unit plugged in?
- Is the power outlet switched on?
- Is the Full Water indicator on?  
(If so empty the condensed water)

### Unit does not seem to cool effectively

- Is the room too large?
- Is there direct sunlight onto the unit?  
(Close curtains and pull down blinds)
- Are windows or doors open?
- Is there another heat source in the room?
- Is the filter dusty or contaminated?
- Is the air intake blocked?
- Is the outlet duct venting the hot air properly?
- Is the room temperature below your selected temperature?

### Too Noisy

Is the unit positioned on an uneven hard floor surface creating vibration?

**Note:** A soft carpeted surface may absorb excessive vibration.

### Specifications

<b>Model</b>	CWAC11
<b>Capacity</b>	10,000 Btu/h
<b>Current</b>	4.3A
<b>Power</b>	950W
<b>Rated Current</b>	5.8A
<b>Rated Input Power</b>	1170W
<b>Airflow Volume</b>	350m <sup>3</sup> /h
<b>Rated Volt</b>	220 - 240V
<b>Rated Frequency</b>	50Hz
<b>LRA of Compressor</b>	15A
<b>Noise</b>	53dB(A)
<b>Weight</b>	26kg
<b>Water Proof Protection</b>	IPX0
<b>Refrigerant / Charge</b>	R410A/0.42KG
<b>Max. Low Pressure</b>	2.1MPa
<b>Max. High Pressure</b>	4.2MPa

**Fault code, description and actions are as follows:**

### Low Temperature (Frost Prevention)



The unit is fitted with a frost protection device to avoid excessive formation of ice. The unit will start automatically when defrosting process is completed.

### Sensor Failure



The unit has malfunctioned, please contact customer service.

### Water Tank Full



Empty the water tank. Follow instructions as given in the water drainage section.  
This unit is built in accordance with relevant safety and performance standards. An electrical specialist must carry out repairs.