

Slimline Plug-in Wireless Door Chime

DC680 Series 3

Installation and Operating Instructions

Introduction

The Wireless Door Chime consists of two separate units:-

1. Push Button Unit (Transmitter)
2. Chime Unit (Receiver)

These units are completely self-contained and no wiring between them is necessary.

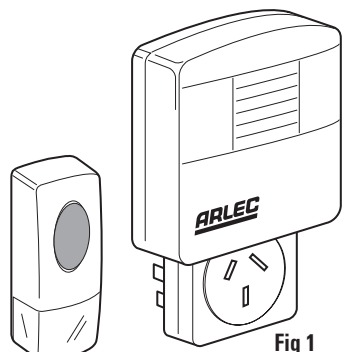

Fig 1

Range

Up to 50 metres.

NOTE: Range depends on location, temperature, and battery condition.

Push Button

1. Push Button unit is operated by 1 x 3 volt Lithium battery (CR2032 - included).
2. Remove the back of case by first removing the clear name tag cover by sliding straight off, then pushing in the tab on the bottom with a small, flat screwdriver.

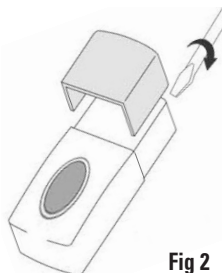

Fig 2

1

3. The 3 volt lithium battery (CR2032) is already installed. Simply pull off the isolation strip which will allow the battery to make electrical contact.

To Replace the Battery

Remove the locking screw from the battery holder clip and remove old battery. Insert 1 x 3 volt lithium battery (type CR2032) in the battery compartment, ensuring the battery polarity is correct as in Fig. 3. Replace clip and tighten locking screw to hold battery firmly in place.



Remove Isolation Strip

Fig 3

Chime Unit

The Chime Unit is powered by 240 volt and should be plugged into any convenient household power point.

Installation

Chime Unit

Plug the Chime Unit into any household power point and switch power on. The Chime Unit will beep twice to indicate it is ready. Press the push button unit to test the chime.

Push Button Unit

The Push Button unit has two mounting holes on rear plate of unit that must be pushed through before unit can be mounted.

1. Remove rear plate of unit (see battery installation).
2. Push through tabs in mounting holes.
3. Using the back plate of the Push Button unit as a guide, mark the position of holes onto mounting surface.
4. Drill appropriately sized holes and insert wall plugs if required.
5. Secure the back plate of Push Button unit to mounting unit.
6. Clip Push Button unit to back plate.

Alternatively the Push Button unit can be attached to smooth mounting surfaces such as painted wood, glass and plastic using Self-Adhesive Pad (supplied).

2

Door Chime Operation

Once the Push Button and Chime units have been installed in their desired locations, the system is ready for use.

Depress button on Push Button unit momentarily, and chime should sound. Press button again to repeat. Continual pressing of the button will not repeat the chime.

If chime fails to sound, check batteries in push button and check power is on to Chime Unit.

Tone Selection

The Wireless Door Chime is supplied with 8 built-in chimes

- | | |
|-------------------|--------------------|
| Westminster Chime | Twinkle Twinkle |
| Double Ding-Dong | It's a Small World |
| Circus Theme | Dog Barking |
| Banjo on My Knee | Telephone Ring |

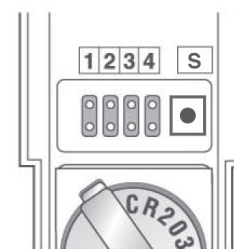

Fig 4

To change the chime tune, remove the Push Button Unit's rear cover (Ref. Fig. 2)

Inside the Push Button Unit locate the small Tune Selector push button marked 'S' (Ref. Fig. 4). Each time that this Tune Selector push button is pressed, the next of the 8 melodies will be played. You can step through and listen to each in turn. When you hear the melody you wish to choose, do not press the tune selector again. The chime will play the selected melody each time the bell press is pushed. At any time you can select another melody by repeating the tune selector button process.

Refit the Push Button Unit rear cover. Whenever the Push Button Unit battery is fitted or replaced, the chime tune may default to the Westminster Chime.

3

House Code Selection

Should your Door Chime unit activate intermittently for no reason at all, it is possible that the uncontrolled activation may be caused by another unit operating nearby on the same frequency coding.

The coded frequency of the Push Button transmitter and Door Chime receiver can be changed to avoid this problem.

1. Remove rear of Push Button unit.
2. The house codes are set by a row of four black jumper connections located on the rear of the Push Button unit (Fig. 5). These jumpers are labelled 1, 2, 3, 4 respectively and can be altered by removing selected jumpers to give sixteen separate codes.
3. To change code remove or add one or more black jumpers from the four located on the rear of the Push Button unit.
4. Remove Chime unit from power point for about 30 seconds. This will reset the frequency coding memory in the chime unit.
5. Plug the Chime Unit in again and switch on. It should beep twice, indicating it is ready to accept a new frequency coding.
6. Press the Push Button unit. The Chime Unit should operate, indicating it has accepted the new coding.

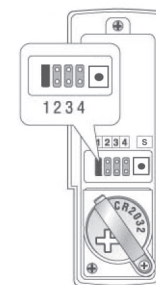

Fig 5

If your chime continues to activate intermittently, repeat above process to change code.

NOTE: Always keep spare or unused jumpers in a safe place for future use.

4

Trouble Shooting & User Hints

Problem	Possible Cause	Suggested Remedy
Chime does not sound.	1. Units are out of range (max. range 50 metres).	Operate the Chime unit within the operation range (50 metres).
	2. Push Button and Chime units are not on same frequency coding.	Re-set the frequency coding (see House Code Selection).
	3. Flat Push Button battery.	Change the battery.
	4. Wrong polarity of battery in Push Button.	Re-insert battery with polarity to match markings.
Chime sounds without Push Button being pressed	1. A power interruption to the Door Chime unit plus a similar door chime product operating nearby has caused the chime unit to reset to the incorrect House Code	A. Switch off the Chime Unit for at least 30 seconds. Switch on again. It should beep twice. Press the Push Button to operate the chime. This re-sets the House Code in the Chime Unit or; B. Re-set the frequency coding (see House Code Selection).
	2. A similar Wireless Door Chime product is operating nearby on the same House Code.	Re-set the House Code (see House Code Selection).
	3. Interference from CBs, Taxis or remote control toys operating on the same frequency.	Re-set the House Code (see House Code Selection).

5

Important Notes

1. The operation and range of your Wireless Door Chime depends on location, temperature and battery condition.
2. Try different locations in your home, ideally more than 1 metre from the floor. Move Chime unit closer to Push Button unit to improve operation.
3. Do not expose either unit to rain or immerse in water.
4. Avoid locations where the Push Button unit is exposed to direct summer sunlight.
5. Do not leave exhausted batteries in Push Button unit.
6. Clean only with a damp cloth and mild detergent. Do not use solvents.

Security

When you are away from home for long periods you may wish to leave your Chime Unit with one of your neighbours so that they can monitor callers to your house during your absence.

6

Arlec Guarantee*

Arlec guarantees this product against defects of materials and workmanship for a period of 12 months from the date of purchase provided that the product is used in accordance with Arlec's recommendations and within such voltage and current limits as are specified by Arlec in relation to the product. Arlec will at its own option make good, replace with the same or similar product, or provide credit for any product manufactured or supplied by it, which proves to be defective within the limits set out above provided that no repairs, alterations or modifications to the product have been undertaken or attempted, other than by the company or its authorised agents. Should the purchaser wish to make a claim under the guarantee, the product should be returned pre-paid to the place of purchase. This guarantee is in addition to and does not take away from any rights available to the consumer under the Trade Practices Act and the State consumer protection legislation.

Proof of Purchase

Please retain your purchase receipt for all warranty claims.

The operating frequency of this unit falls within the permissible frequency range as prescribed by the relevant government authority.

* Excludes batteries.

7

8